



## WINTERIZING

At the end of the camping season, the RV will need to be prepped for storage. These recommendations will help maintain and protect the RV during the colder months, and/or during a long period of inactivity. These recommendations will not apply to all units.

### PERSONAL ITEMS -

Remove all personal items that could cause damage if frozen or left unattended. Remove all food from the RV, any food left will attract mice and bugs. Make sure to remove all canned items as well. Canned items can freeze and bust, causing damage. Remove all clothing, linens and cloth items from the RV. Remove all personal items and valuables, especially if the RV is being stored in a public storage lot. Double check all storage compartments for cleaning supplies, food and personal items. Personal items and linens can be stored in a plastic storage bin, in a dry and clean area, do not keep anything in the RV.

### APPLIANCES -

Turn off and unplug all appliances. All appliances can be cleaned with mild soap and water. Make sure all food is removed from the refrigerator. Once cleaned the refrigerator should remain slightly open. Air conditioners and roof vent/fans, clean out all the dust and debris, clean any filters (if applicable).

### ELECTRICAL -

Turn off all electrical components in the RV, as well as the main circuit breaker. Some units may be equipped with a battery disconnect switch, that should be off as well. Disconnect the battery and remove from the unit. The battery should be stored in dry and warm location, fully charged. All batteries should be removed from small appliances such as remotes and alarms.

### INTERIOR -

Before storage, the interior of the RV should be thoroughly cleaned. All surfaces should be cleaned with mild soap and water; no harsh abrasive cleaners should be used. Clean and remove all food crumbs/partials, and all dirt debris.

### LP -

Close all the LP lines and remove the LP tank. Store the tank in a sheltered location, do not store the tank inside the RV. The LP regulator and connection fittings can be covered with a plastic bag for extra protection.

## DOORS & WINDOWS -

All doors and windows should be closed and locked. Windows should be cleaned with mild soap and water, remove all debris from corners and edges. Check all seals around the doors and windows, complete any repairs needed before storage. Apply lubricant to all door hinges and window latches and all other moving parts. Lubricant can be applied to the seals to help prevent against any possible cracking.

## PLUMBING -

All the Luna models are all plumbed the same, these winterizing and de-winterizing steps can be applied to all the Luna models. The labeled picture below shows each valves in the plumbing system, also labeled parts of the plumbing system.

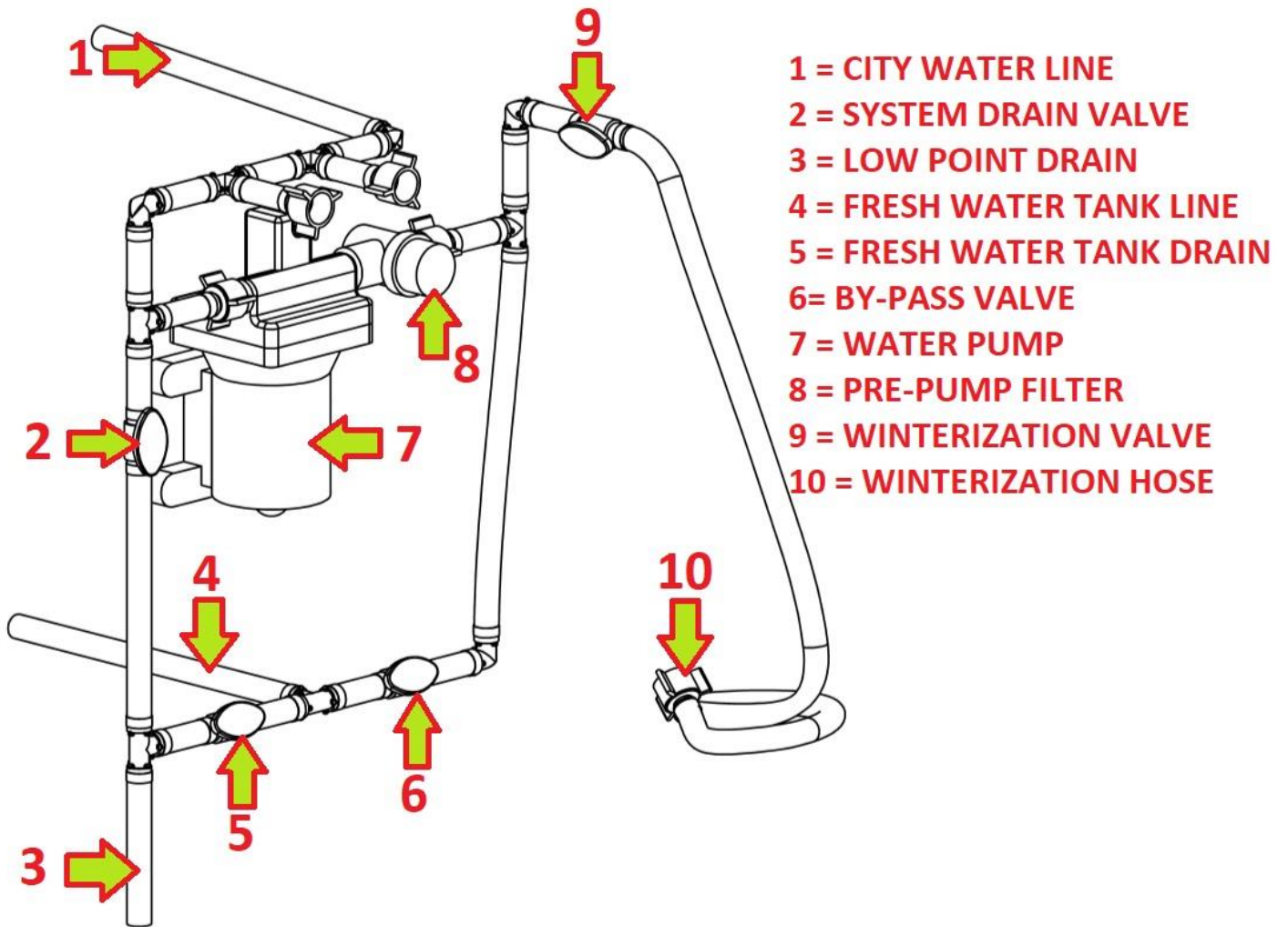

Using the labeled diagram, the valves should be in the following positions for various operations.

**OPERATING (from tank)**

**# 2 = CLOSED # 5 = CLOSED # 6 = OPEN # 9 = CLOSED**

Operating (From Tank)

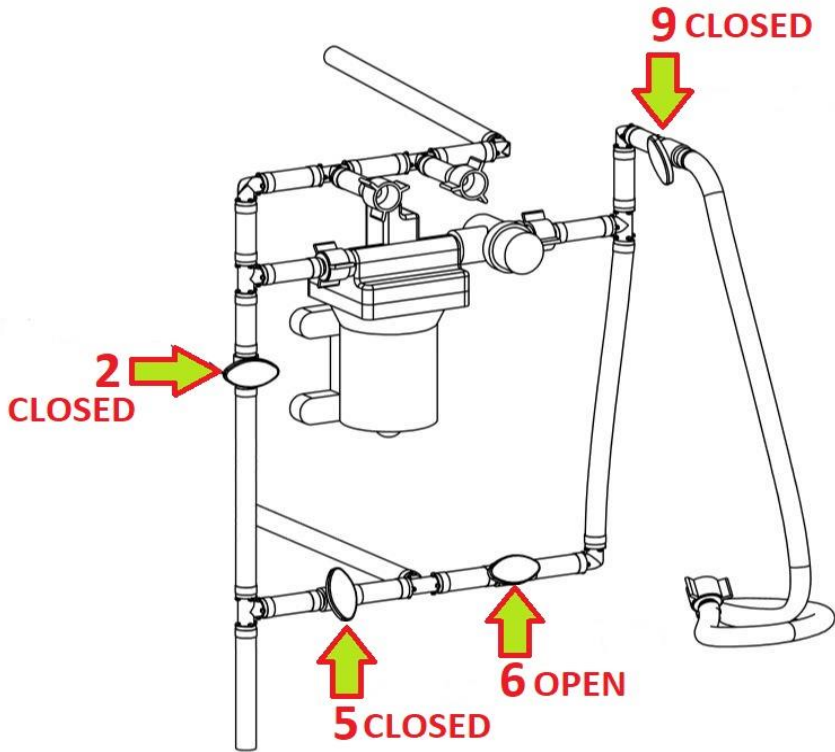

**CITY WATER HOOKUP**

**# 2 = CLOSED # 5 = CLOSED # 6 = CLOSED # 9 = CLOSED**

Operating (From City Water)

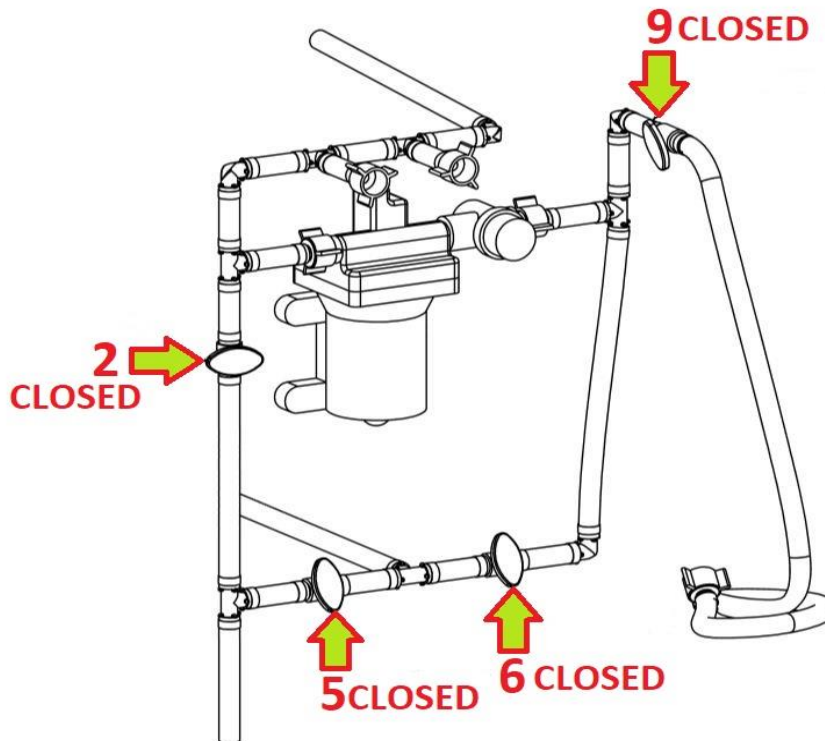

### DRAINING THE SYSTEM (prep for winterizing)

# 2 = OPEN # 5 = OPEN # 6 = OPEN # 9 = CLOSED

Drain the water tank, leave the faucet open, and get as much water out of the unit as possible. To make sure all the water is out of the system, the lines can be kept open for a few hours.

Draining The System (Prep For Winterize)

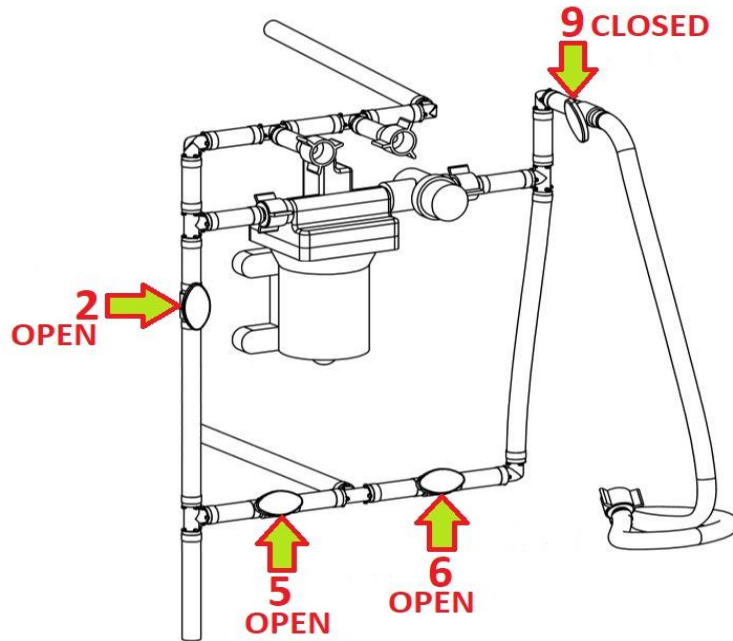

### WINTERIZE

# 2 = CLOSED # 5 = CLOSED # 6 = CLOSED # 9 = OPEN

Pumping non-toxic RV antifreeze into the system, will help protect the lines. The valves need to be closed, so RV antifreeze does not pump into the tank. Make sure to keep the sink faucet on.

Dip "10" into the RV antifreeze, then turn on the pump. Once there is fluid in the sink, closed the faucet and turn the pump off. Make sure about a cup or more of RV antifreeze runs down the sink to get into the "P" trap.

Once the RV antifreeze is pumped through the system, close # 4 valve.

Winterize

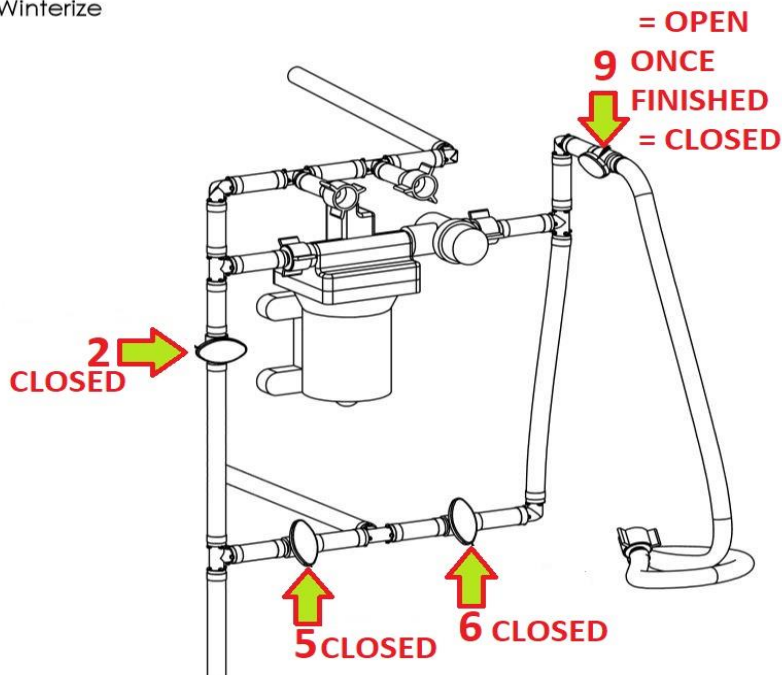

## DRAIN / FLUSH SYSTEM (de-winterize)

# 2 = OPEN # 5 = OPEN # 6 = OPEN #9 = CLOSED

The system will need to be drained, to get all the RV antifreeze out. Run about one tank of water through the system. The RV antifreeze will be output through the faucet. For a few minutes to get water through all the lines, “draining the system” valves can be turned on, then off.

Operating (From Tank)

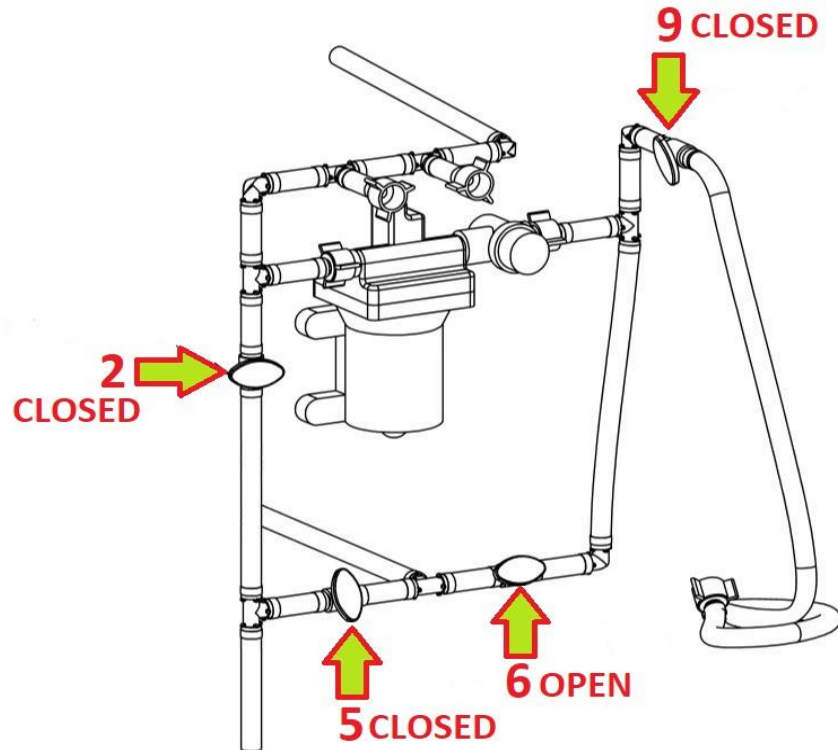

## EXTERIOR -

Properly store all exterior tents and awnings. Awning and tents should be cleaned, making sure all tree sap, insect and any corrosive materials are removed. The exterior of the RV should be cleaned with mild soap and water, avoid using cleaners with abrasives. While cleaning the exterior, make sure all tree sap, bird droppings, insects, road tar and any corrosive materials are removed. The underbelly of the RV should be cleaned as well, to wash off all debris. RV protective wax can be applied, if desired. After thoroughly cleaning the exterior of the RV, inspect all seals around the roof trim, windows, doors, fenders, etc. Re-caulk any areas that have thinned or started to break apart. For further protection, an RV cover can be purchased separately through a dealership or a camping website.

## ROOF -

Clean the roof with mild soap and water, removing all tree sap, bird dropping, insects and debris. After cleaning, inspect all the sealant along the edges and corners. Re-caulk and any areas that have thinned or are starting to break apart. Make sure the roof vent/fan is closed. The roof vent/fan and/or AC can be covered for further prevention of any foreign objects or mice from trying to enter the RV. If it snows throughout the time the RV is in storage, try to keep as much snow off the roof as possible. Keeping the roof clean will help prevent damage to the roof, the extra weight of snow on the roof is not desirable.

## **PARKING -**

When the complete winterizing process is finished, the RV will need to be parked properly. The RV should remain as level as possible. Leveling blocks can be used, they will help take pressure of the tires and will help keep the RV level. Stabilizer jacks can be used with the leveling blocks. If the RV is sitting on the tires for an extended amount of time, flat spots could occur and if they become underinflated, the tires could begin to crack. Avoid storage parking the RV on asphalt, dirt, mud, grass or gravel. A piece of wood, larger than the tire can be placed under the tire for protection. For further protection, tire covers can be purchased to help prevent against cracking and dry rot.

## **MAINTENANCE / INSPECTION –**

During the process of winterizing, it would be a perfect time to complete a full inspection of the RV. The below list is recommendations of parts to check on the RV to make sure they are in good working condition.

- Appliances - proper operation & free from defects
- Battery - connections and operation
- Bolts & Hardware - free from defects and tight & secure
- Brakes – connection & operation
- Clean the air conditioner and/or Air Maxx fan
- Door latches & locks - proper operation
- Hitch system & Safety Chains - proper operation & free of cracks and loose components
- Interior & Exterior lights - proper operation & free from defects
- LP gas system - proper operation and no leaks
- LP hose pigtail connection
- Roof rack system - hardware tight & secure and free of cracks
- Roof sealant - free of cracks and tight & secure
- Safety alarms - proper operation
- Seals - on doors, windows and other openings, free of cracks & tight & secure
- Shore cord - proper operation
- Sidewall sealant - free of cracks and tight & secure
- Stab jacks - proper operations & hardware tight & secure
- Tires - lug nuts, pressure & tread wear & rotation
- Wash - exterior